

**TECHNICAL GUIDE
&
PARTS CATALOGUE**

Cal.VD54C

ANALOGUE QUARTZ

SII Products

PARTS CATALOGUE / TECHNICAL GUIDE

Cal.VD54C



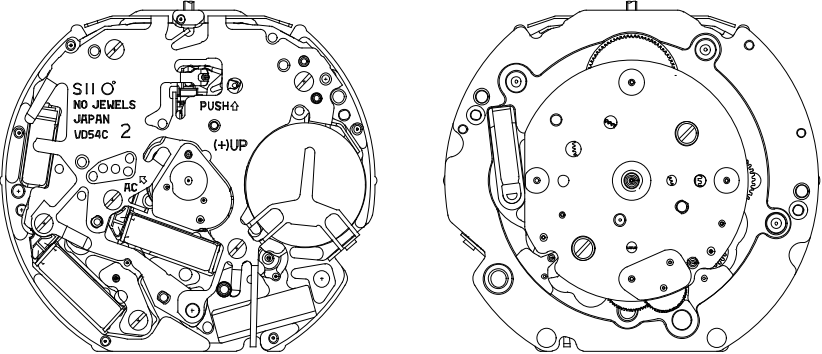

[SPECIFICATION]

Version-01

Item		Cal. No.	VD54C			
Movement						
Movement size	Outside diameter	(ϕD)	(3H - 9H)	(12H - 6H)		
		$\phi 29.50 \text{ mm}$	$\times 26.00 \text{ mm}$	\times	—	
	Casing diameter	(ϕD)	(3H - 9H)	(12H - 6H)		
		$\phi 28.80 \text{ mm}$	\times	—	\times	—
	Total height	3.97 mm				
Time indication		3 Hands (Hour , Minute , Second) Chronograph , 24H indicator				
Driving System		Two pole stepping motor Step motor 2 pieces				
Additional mechanism		Electronic circuit reset switch Second setting device [Time] Indicated by Hour , Minute , Second and 24-Hour hands [Stop watch] Up to 60 minute in 1 second split time				
Antimagnetic		$\geq 1600 \text{ A/m}$				
Accuracy		Less than ± 20 seconds : Monthly rate at normal temperature range				
Battery		SR920SW (SEIZAIKEN) Silver oxide battery $\phi 9.5 \times t 2.0 \text{ mm}$ Battery life is approximately 3 years				
Measuring gate by quartz tester		Use 10-second gate *Set the winding stem with crown at the normal position				
Jewels		0 Jewel				

Disassembling procedures Figs. ① ⇒ ③⑨
Reassembling procedures Figs. ③⑨ ⇒ ①

Lubricating : Types of oil Oil quantity

 Moebius 9010  Normal quantity
 Moebius 9030
 S-6

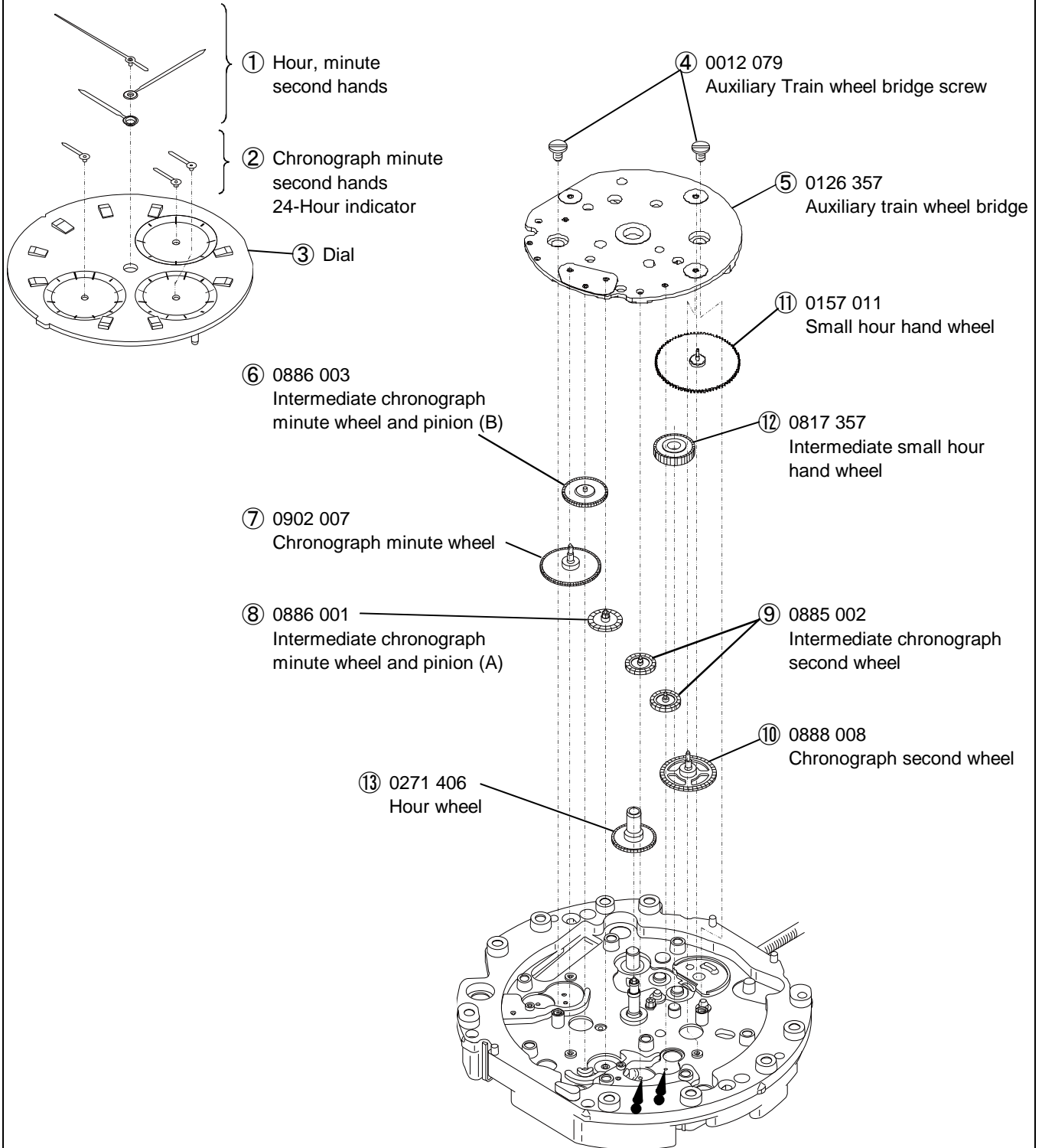

*All parts code are subject to change without notice.

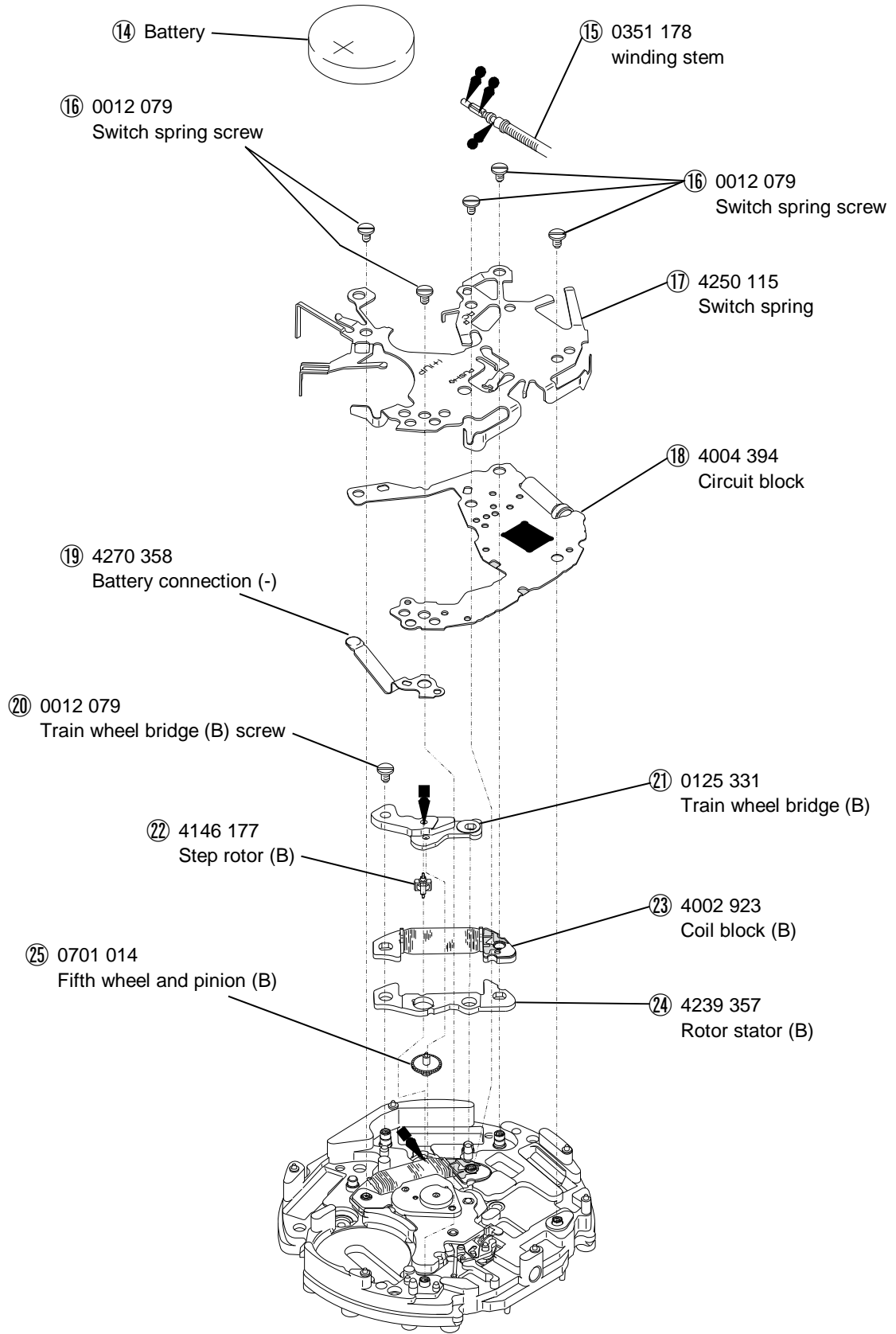

***All parts code are subject to change without notice.**

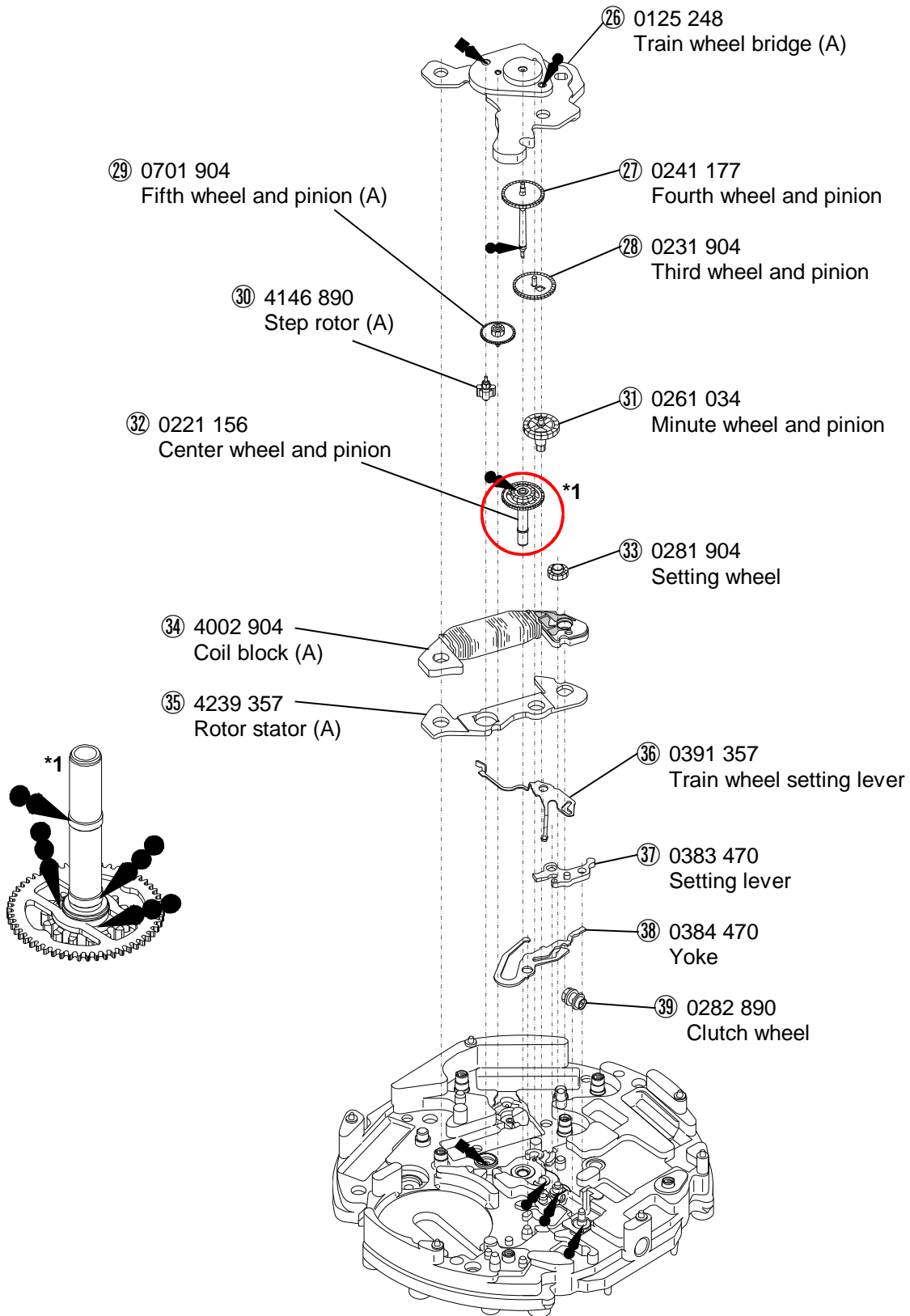

***All parts code are subject to change without notice.**

•The explanation here is only for the particular point of Cal.VD54C

1.REMARKS ON INSTALLING THE BATTERY

- 1) After the battery is replaced with a new one or after the battery is reinstalled following the repairing procedures, Be sure to touch the short-circuit the AC terminal of circuit block and the switch spring with conductive tweezers to reset the circuit as illustrated at right.

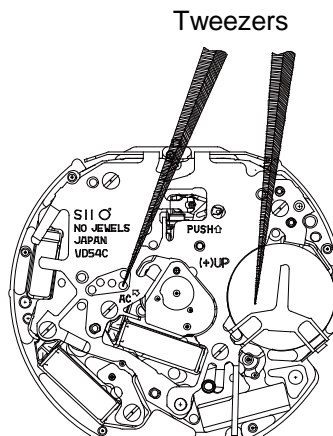

- 2) When the battery replaced with a new one, the time information stored in the built-in IC and the time indicated by the stopwatch hands do not correspond with each other. Reset the stopwatch hands to "0" position following the procedure below. If the stopwatch hands should move improperly, also follow the same procedure.

ORDER

- ① Pull the crown.
- ② Keep the buttons "A" and "B" pressed at the same time for 2 seconds, and then, release the buttons. The stopwatch second hand move back and returned to where it was.
- ③ Press button "A" or "B" to reset the stopwatch second and minute hands to"0" position.
 - * By pressing button "A" , the hands move counter clockwise.
 - * By pressing button "B", the hands move clockwise.
- ④ Turn the crown to set the hour, minute and 24-hour hands to the desired time, and push the crown back to the normal position.

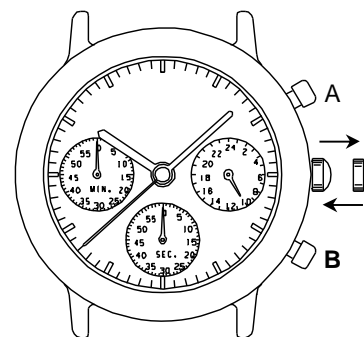

1.REMARKS ON INSTALLING THE BATTERY

(1) HAND

•How to install the hands

Place the movement directly on a flat metal plate or the like and press in the hands.

* Install the hour , minute and second hands at the "12" o'clock position.

* Install the chrono minute and second hands at the "0" o'clock position.

*Install the 24-Hour indicator at the "24" position.

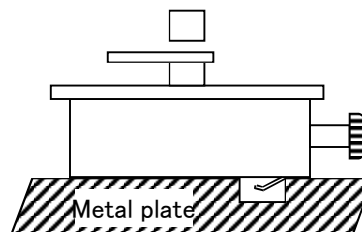

[Reference] The power of press hands

Minute & Hour Hands < 5kg

Second Hand < 5kg

Chrono Minute & Second < 3kg

24-Hour indicator < 3kg

(2) Battery

•How to install the battery

① Remove the hook of the switch springs battery clamp portion.

② Insert the battery sideways, and have the hook of the switch springs battery clamp portion catch the main plate.

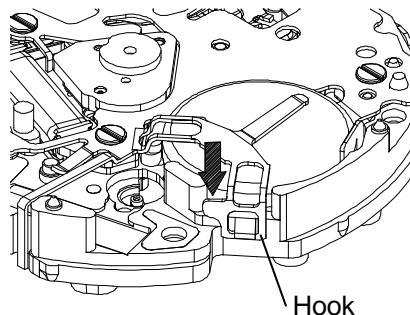

Battery clamp position

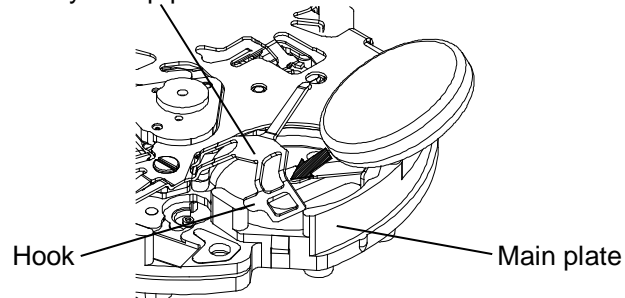

(3) Winding stem

•How to remove

While pushing the indented portion of the arrow pull out the winding stem.

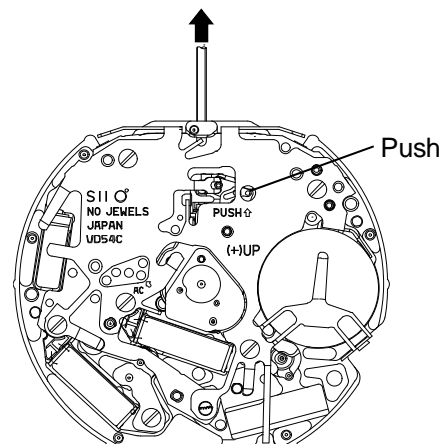

DISPLAY AND CROWN / BUTTON OPERATION

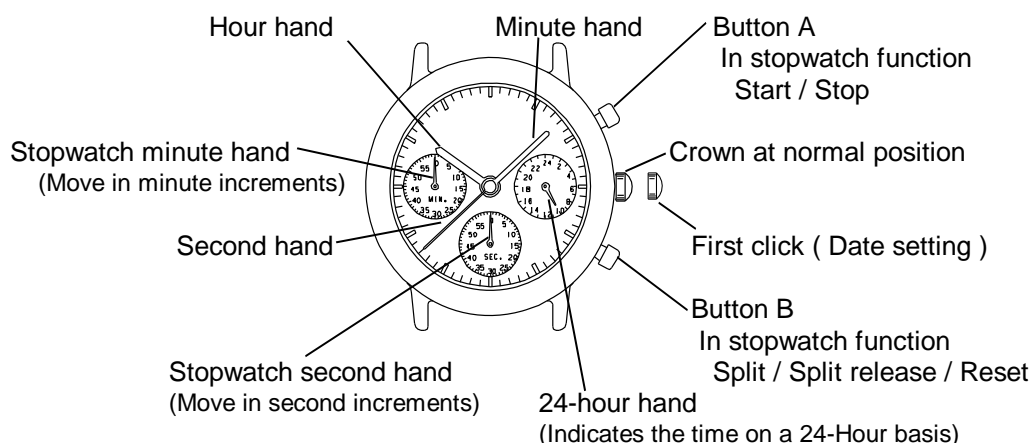

ADJUSTING THE STOPWATCH HAND POSITION

Before setting the time , check if the stopwatch second and minute hands are in the "0"(12 o'clock) position.
*if the stopwatch is in use , press the button in the following order to reset it , and then , check if the hands return to "0" position. (For details , see "HOW TO USE THE STOPWATCH")

- * If the stopwatch is counting : A → B
- * If the stopwatch is stopped : B
- * If the split time is displayed : B → A → B

If either of the stopwatch hands are not in the "0" position , reset them following the procedure below.

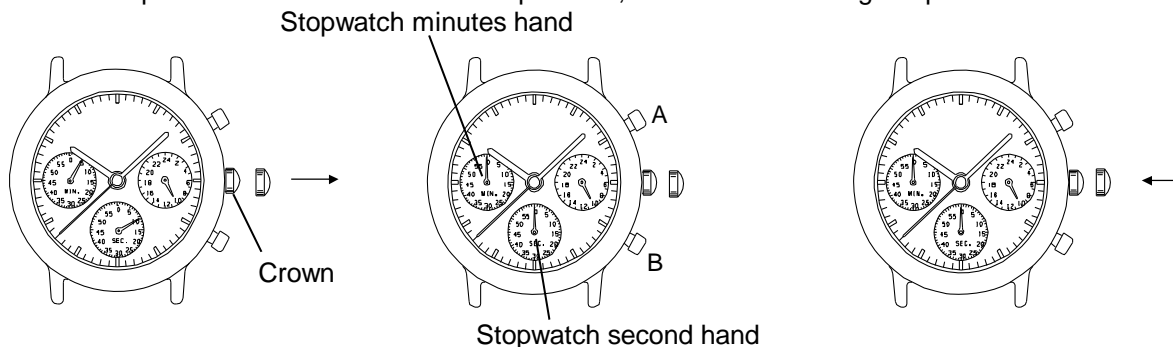

1.Pull out the crown.

2.Press button A or B to reset the stopwatch second and minute hands to "0"position.

3.Push the crown back to the normal position.

*By pressing button A the hands move counter clockwise.

*By pressing button B the hands move counter clockwise.

TIME SETTING

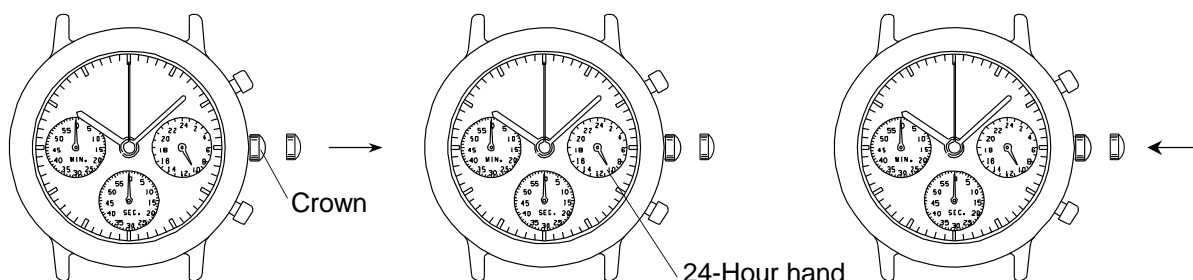

1. Pull out the crown to the second hand is at the 12 o'clock position.

The second hand will stop on the spot.

* Do not press any button. Otherwise, the chronograph hands will move.

2. Turn the crown to set the hour, minute and 24-hour hands to the desired time.

As the hour hand moves, the 24-hour hand also moves correspondingly.

When setting the hour hand, check that the 24-hour hand is set properly.

3. Push the crown back in to the normal position in accordance with a time signal.

HOW TO USE THE STOPWATCH

- The measured time is indicated by the stopwatch hands that move independently of the center and 24-hour hands.
- The stopwatch can measure up to 60 minutes in seconds.

(The watch indicates the measured time in second increments by ignoring off the 1/10 seconds obtained.)

(Standard measurement)

Ex) 100m race (Press the buttons in the following order A → A → B)

START → STOP (Finish) → RESET (Reset to "0'00")

Stopwatch minute hand

stopwatch second hand

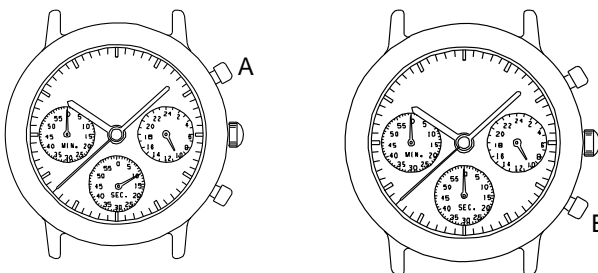

10 second

(Accumulated elapsed time measurement)

Ex) Basketball game (Press the buttons in the following order A → A / A ... → A → B)

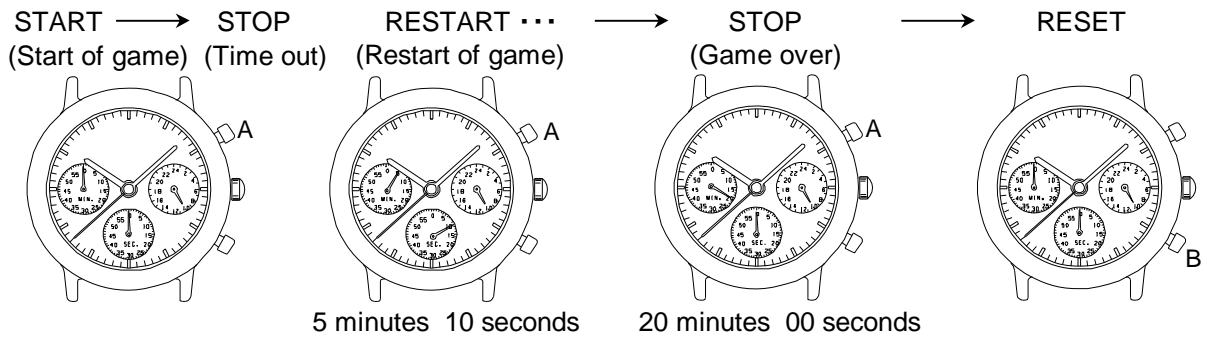

*Restart and stop of the stopwatch can be repeated as many times as necessary by pressing button A.

(Split time measurement)

Ex) 5,000m race (Press the buttons in the following order A → B / B ... → A → B)

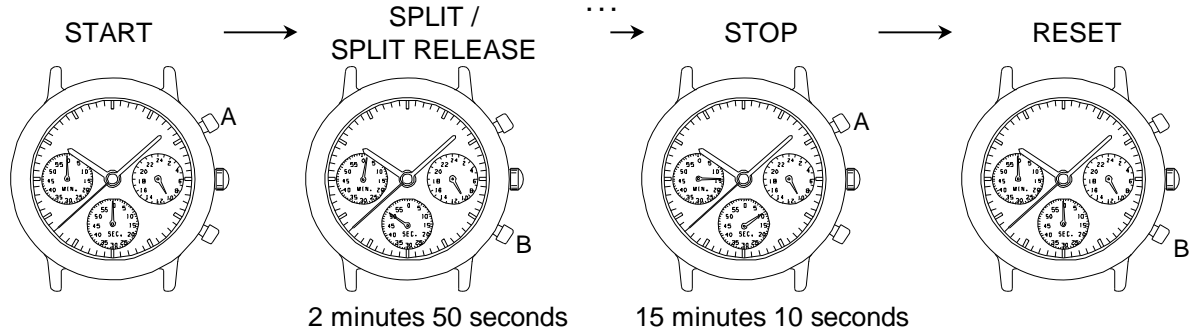

* Measurement and release of the split time can be repeated as many times as necessary by pressing button B.